

Specification	AXLE207M	Rev.: 1	Date: 2014-04-06
----------------------	-----------------	---------	------------------

Oscillator type: (VC)TCXO in DIL14 package

Parameter	min.	typ.	max.	Unit	Condition
Frequency range	6		190	MHz	Clipped Sine wave
	6		190	MHz	Sine wave
	1		800		HCMOS, PECL, LVDS
Frequency stability				ppm	
vs. operating temperature range	±0.5 to ±5 See tables 1 & 2			ppm	Option 4 & 5
vs. supply voltage variation		±0.1	±0.3	ppm	V _S ±5 %
vs. load change			±0.2	ppm	Load ±10 %
Long term (aging) per year			±1	ppm	@+40°C
Frequency adjustment range					
Mechanical (internal trimmer)	±3			ppm	Option 1 = blank
Electronic Frequency Control (EFC)	±5			ppm	Option 1 = "V"
EFC voltage V _C	0.15	1.65	3.15	V	Option 2 = "3"
	0.5	2.5	4.5	V	Option 2 = "5"
EFC slope (Δf / ΔV _C)	Positive				
EFC input impedance	100			kΩ	
RF output					
Signal waveform	Clipped Sine wave Sine wave HCMOS PECL LVDS				Option 3 = "C" Option 3 = "S" Option 3 = "H" Option 3 = "P" Option 3 = "L"
Load	10 kΩ 10 pF 50 Ω 15 pF 50 Ω + Bias				Option 3 = "C" Option 3 = "S" Option 3 = "H" Option 3 = "P" or "L"
Amplitude	0.8			V p-p	Option 3 = "C" / 3.3 V
	1.0			V p-p	Option 3 = "C" / 5.0 V
		0		dBm	Option 3 = "S" / 3.3 V
		+10		dBm	Option 3 = "S" / 5.0 V
	According to relevant Logic Standard				Option 3 = "H", "P", "L"
Supply voltage V_S	3.15	3.3	3.45	V	Option 2 = "3"
	4.75	5.0	5.25	V	Option 2 = "5"
Current consumption (Note 2)	2 ~ 30			mA	Option 3 = "C"
	12 ~ 30			mA	Option 3 = "S"
	15 ~ 50			mA	Option 3 = "H"
	25 ~ 100			mA	Option 3 = "P" or "L"
Enclosure (see drawing) (LxWxH) (Note 3)	20.7x13.1x7.5 max.			mm	IEC 60679-3 CO 02
Weight			5	g	
Packing	Palette				IEC 60286-3

Notes:

1. Terminology and test conditions are according to IEC60679-1 and MIL-PRF-55310, unless otherwise stated
2. Depending on frequency and supply voltage
3. Reduced package height H = 5.1 mm max. on request
4. All combinations of options might not be available. Please consult factory

Absolute Maximum Ratings

Parameter	min.	max.	Unit	Condition
Supply Voltage V_S	-0.5	$V_S + 10\%$	V	V_S to GND
Control Voltage V_C	-0.5	6	V	V_C to GND
Storage Temperature	-55	+105	°C	

Frequency stability vs. temperature

Option 4	Stability [ppm]
05	±0.5
10	±1.0
15	±1.5
20	±2.0
25	±2.5
30	±3.0
35	±3.5
50	±5.0

Table 1

Lower Temperature		Upper Temperature	
Option 5	T [°C]	Option 5	T [°C]
0	0	A	+50
1	-10	B	+60
2	-20	C	+70
3	-30	D	+75
4	-40	E	+80
		F	+85

Table 2

Ordering Code

Model	Option 1 [EFC]*	Option 2 [Supply Voltage]	Option 3 [RF output]	Option 4 [Stability]	Option 5 [Temperature range]	Revision	Frequency [MHz]
AXLE207M	_ or "V"	3 or 5	C, S, H, P, L	Table 1	Table 2	Rev.1	10.000

Example: AXLE207M-V-5-S-10-3D_Rev.1 – 10.000 MHz

Handling and Testing

Parameter	Procedure	Source
Handling and Testing	Application Note AXAN-011	www.axtal.com
Processing	Application Note AXAN-012	www.axtal.com
Parameter	Procedure	Condition
Electrostatic discharge (ESD)		
THD devices	IEC60749-26	HBM 2000 V
SMD devices	IEC60749-27	MM 200 V
Washable	<input checked="" type="checkbox"/> Yes <input type="checkbox"/> No	
RoHS compliant	<input checked="" type="checkbox"/> Yes <input type="checkbox"/> No	

Enclosure drawing

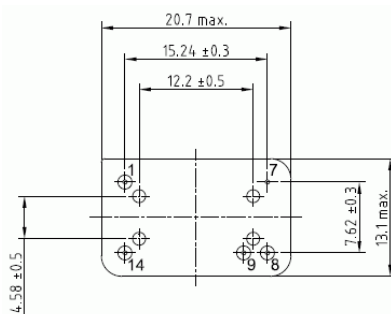
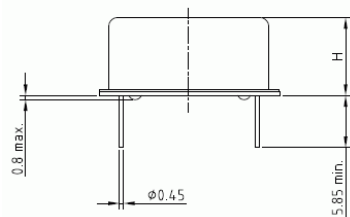
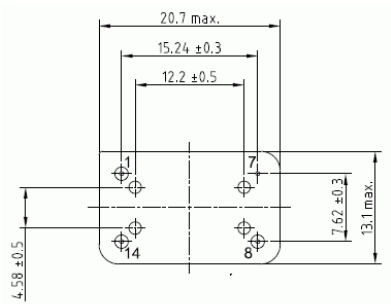

* PECL and LVDS output with EFC

Pin connections (Without EFC)

Pin #	Symbol	Function
1	N.C. or Comp OUT	No Connection or Complementary RF Output (PECL and LVDS)
7	GND	Ground
8	RF OUT	RF Output
9	-	- Pin Not Present -
14	V _S	Supply Voltage

Pin connections (With EFC)

Pin #	Symbol	Function
1	V _C	Control Voltage (EFC)
7	GND	Ground
8	RF OUT	RF Output
9	Comp OUT	Complementary RF Output (PECL and LVDS)
14	V _S	Supply Voltage

Environmental conditions

Test	IEC 60068 Part ...	IEC 60679-1 Clause	MIL-STD-202G Method	MIL-STD-810F Method	MIL-PRF-55310D Clause	Test conditions (IEC)
Sealing tests (if applicable)	2-17	5.6.2	112E		3.6.1.2	Gross leak: Test Qc, Fine leak: Test Qk
Solderability	2-20	5.6.3	208H		3.6.52	Test Ta Method 1
Resistance to soldering heat	2-58		210F		3.6.48	Test Td ₁ Method 2 Test Td ₂ Method 2
Shock*	2-27	5.6.8	213B	516.4	3.6.40	Test Ea, 3 x per axes 100g, 6 ms half-sine pulse
Vibration, sinusoidal*	2-6	5.6.7.1	201A 204D	516.4-4	3.6.38.1 3.6.38.2	Test Fc, 30 min per axes, 10 Hz - 55 Hz 0,75mm; 55 Hz - 2 kHz, 10g
Vibration, random*	2-64	5.6.7.3	214A	514.5	3.6.38.3 3.6.38.4	Test Fdb
Endurance tests			108A			
- ageing		5.7.1			4.8.35	30 days @ 85°C, OXCO @25°C
- extended aging		5.7.2				1000h, 2000h, 8000h @85°C

Other environmental conditions on request

Data sheet is for information purposes only and may be subject to modifications or may be discontinued without notice.

Revision History

Rev.	Drawing	Date [dd.mm.yyyy]	Remarks	Author	Checked
1	D1	01.10.2012	Editorial changes	BN	BN
1	D2	06.04.2014	Environmental conditions updated, editorial changes	HH	HH